

# DEL MAR

VENEER COLLECTION

*DMI*  
DMI OFFICE FURNITURE®



7302

Sunset  
Cherry  
Finish

# DELMAR

7302

2



*Construction - The construction featured throughout the Collection consists of wood, wood veneers and select wood product, including solid wood bases. Cases feature mortise and tenon construction with wood cleats, glue, screws, staples and threaded inserts with bolts. Drawers feature dovetail engineering and are constructed with solid wood sides and backs with veneer and veneer banded fronts and 3-ply bottoms. Drawer interiors are sealed.*



*Function - All drawers are suspended on fully extending, metal, ball-bearing slides allowing easy access to the entire drawer. Box drawers have a 75 lb. load bearing rating. File drawers have a 150 lb. load bearing rating. File drawers are equipped with metal rods for side-to-side letter or front-to-back legal hanging files.*

*All desks, credenzas and file cabinets have adjustable levelers. Cable grommets or other openings are strategically located on specific items to facilitate neat and easy cable management.*



With its striking Sapele Pommele veneers, rich Sunset cherry finish and subtle Shaker influences, Del Mar is a handsome, transitional alternative to the customary traditional office environment. Its wood, wood veneer and select wood product construction will hold up to those demanding value, and its deep assortment of office furnishings will provide solutions for a multitude of office needs.

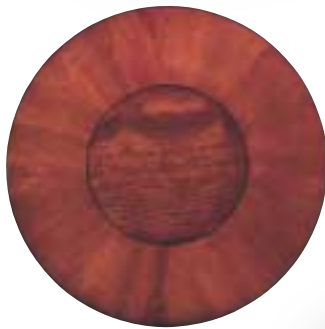

**EXECUTIVE DESK**

**7302-36**

W72 D36 H30

- Felt-lined center drawer with a pencil tray.
- Felt-lined box with a pencil tray / box / file drawer per pedestal.
- File drawers accommodate letter or legal hanging files.
- Kneehole locking pedestals.
- Cable grommet in pedestal ends.



**EXECUTIVE DESK WITH BOW FRONT**

**7302-37**

W72 D42 H30

- Same features as the -36 Executive Desk.

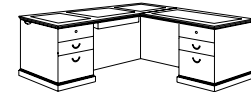

**72" EXECUTIVE RIGHT "L" DESK**

**7302-47**

W72 D84 H30

Consists of:

-570 Executive Left Single Pedestal Desk

W72 D36 H30

-579 Right Single Pedestal Return

W48 D22 H30

*ALSO AVAILABLE:*

*72" EXECUTIVE LEFT "L" DESK*

**7302-48**

W72 D84 H30

Consists of:

-580 Executive Right Single Pedestal Desk

-589 Left Single Pedestal Return

- Felt-lined box with a pencil tray / box / file drawer per pedestal.
- Kneehole locking pedestals.
- File drawers accommodate letter or legal hanging files.
- Desks feature a felt-lined center drawer with a pencil tray.
- 32.75" kneehole on desk.
- Desk has a black cable grommet in the end panel; return has a 3" cable grommet in the top.

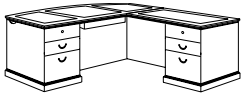

**72" EXECUTIVE RIGHT "L" WITH BOW FRONT DESK**

**7302-67**

W72 D90 H30

Consists of:

- 670 Executive Left Single Bow Front Pedestal Desk W72 D42 H30
- 579 Executive Right Single Pedestal Return W48 D22 H30

**ALSO AVAILABLE:**

*72" EXECUTIVE LEFT "L" WITH BOW FRONT DESK*

**7302-68**

W72 D90 H30

Consists of:

- 680 Executive Right Single Bow Front Pedestal Desk
- 589 Executive Left Single Pedestal Return

- Same features as the -47 and -48 Executive "L" Desks.

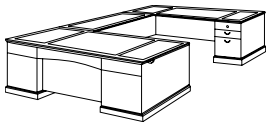

**EXECUTIVE RIGHT "U" DESK**

**7302-57**

W72 D108 H30

Consists of:

- 570 Executive Left Single Pedestal Desk W72 D36 H30
- 571 Executive Right Single Pedestal Credenza W72 D24 H30
- 59 "U" Bridge W48 D24 H30

**ALSO AVAILABLE:**

*EXECUTIVE LEFT "U" DESK*

**7302-58**

W72 D108 H30

Consists of:

- 580 Executive Right Single Pedestal Desk
- 581 Executive Left Single Pedestal Credenza
- 59 "U" Bridge

- Felt-lined box with a pencil tray / box / file drawer per pedestal.
- File drawers accommodate letter or legal hanging files.
- Kneehole locking pedestals.
- Desks feature a felt-lined center drawer with a finished wood pencil tray.
- Desks have a cable grommet in the pedestal ends; credenzas have cable grommets in the pedestal ends and back panels; bridge has a cable grommet in the back panel and the top.



**EXECUTIVE RIGHT "U" WITH BOW FRONT DESK**

**7302-77**

W72 D114 H30

Consists of:

- 670 Executive Left Single Pedestal Bow Front Desk W72 D42 H30
- 571 Executive Right Single Pedestal Credenza W72 D24 H30
- 59 "U" Bridge W48 D24 H30

**ALSO AVAILABLE:**

*EXECUTIVE LEFT "U" WITH BOW FRONT DESK*

**7302-78**

W72 D114 H30

Consists of:

- 680 Executive Right Single Pedestal Bow Front Desk
- 581 Executive Left Single Pedestal Credenza
- 59 "U" Bridge

- Same features as the -57, and -58 Executive "U" Desks.



**EXECUTIVE STORAGE CREDENZA**

**7302-20**

W72 D24 H30

- Two-door cabinet with an adjustable shelf.
- Felt-lined box with a pencil tray / box / file drawer per pedestal.
- File drawers accommodate letter or legal hanging files.



**KNEEHOLE CREDENZA**

**7302-21**

W72 D24 H30

- Felt-lined center drawer has a hinged drop-front for use as a center or keyboard drawer; includes a pencil tray.
- Felt-lined box with a pencil tray / box / file drawer per pedestal.
- File drawers accommodate letter or legal hanging files.
- Kneehole locking pedestals.



**KNEEHOLE CREDENZA WITHOUT RETURN Moulding**

**7302-215**

W69.5 D24 H30

- Same features as -21 Kneehole Credenza.



**LATERAL FILE**

**7302-16**

W36 D24 H30

- Two fully extending, 18" deep lateral file drawers.
- Drawers accommodate letter and /or legal hanging files.
- Central locking.
- Equipped with an anti-tip device.

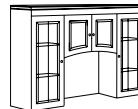

**OVERHEAD STORAGE**

**7302-62**

W72 D16 H48

- Three cabinets with glass paneled doors; each cabinet has a canister light.
- Right and left tower cabinets each have two adjustable glass shelves.
- Euro-style door hinges.



**WALL MOUNTED OVERHEAD STORAGE WITH CRACKLE GLASS DOOR PANELS**

**7302-403**

W69.5 D16 H25

- Three cabinets, each with a canister light.
- Euro-style door hinges.
- Mounts to wall with screws and 2" metal rail.

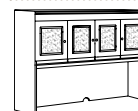

**OVERHEAD STORAGE WITH CRACKLE GLASS DOOR PANELS**

**7302-404**

W69.5 D16 H48

- Three cabinets, each with a canister light.
- Letter organizers.
- Euro-style door hinges.
- Cable accessible.

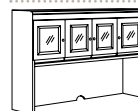

**OVERHEAD STORAGE WITH BEVELED GLASS DOORS**

**7302-625**

W69.5 D16 H48

- Same features as -404 Overhead Storage.

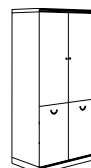

**MEDIA CABINET**

**7302-04**

W42 D24 H78

- Two, two-door cabinets.
- Top cabinet has pocket doors; pull-out /swivel TV shelf; removable pegboard back; 3" cable grommet.
- Bottom cabinet has an adjustable shelf; 3" cable grommet.

# DEL MAR

7302

5

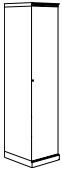

**SINGLE DOOR STORAGE WARDROBE / CABINET**  
**7302-05**  
W24 D18 H78

- Four adjustable / removable shelves.
- Hanger rod.
- Euro-style door hinges.

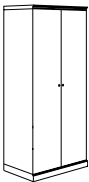

**DOUBLE DOOR STORAGE WARDROBE / CABINET**  
**7302-06**  
W33.75 D24 H78

- Eight adjustable / removable shelves.
- Hanger rod.
- 3" cable grommet in the back panel.
- Euro-style door hinges.

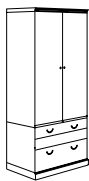

**LATERAL FILE STORAGE CABINET**  
**7302-07**  
W36 D24 H78

- Two lateral file drawers with central locking.
- File drawers accommodate letter and / or legal hanging files.
- Cabinet has two adjustable / removable shelves; Euro-style door hinges; 3" cable grommet in back panel.
- Equipped with an anti-tip device.



**OPEN BOOKCASE**  
**7302-148**  
W36 D16 H48

- Two adjustable shelves.
- Designed to fit atop the -16 lateral file.
- Includes adjustable glides and felt-pads.



**CLOSED BOOKCASE**  
**7302-248**  
W36 D16 H48

- Glass front doors.
- Canister light.
- Two adjustable glass shelves.
- Euro-style door hinges.
- Designed to fit atop the -16 lateral file.
- Includes adjustable glides and felt-pads.



**CENTER BOOKCASE**  
**7302-108**  
W33.5 D16 H78

- Four adjustable shelves; fixed base shelf.

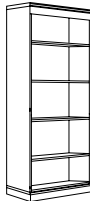

**LEFT HAND FACING BOOKCASE**  
**7302-118**  
W34.75 D16 H78

- Four adjustable shelves; fixed base shelf.



**RIGHT HAND FACING BOOKCASE**  
**7302-128**  
W34.75 D16 H78

- Four adjustable shelves; fixed base shelf.

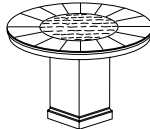

**42" ROUND CONFERENCE TABLE**  
**7302-89**  
42" diameter x 30" height

- Consists of:
- 011 Round 42" Top
  - 003 Square Pedestal Base

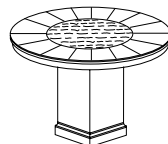

**48" ROUND CONFERENCE TABLE**  
**7302-90**  
48" diameter x 30" height

- Consists of:
- 016 Round 48" Top
  - 003 Square Pedestal Base

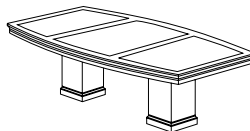

**8' BOAT TOP CONFERENCE TABLE**  
**7302-96**  
W96 x D36-42 x H30

- 004 Boat Shaped 8' Top
- 003 Square Pedestal Bases (2)

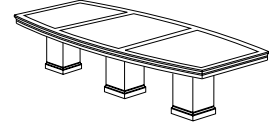

**10' BOAT TOP CONFERENCE TABLE**  
**7302-120**

- W120 x D36-48 x H30
- 005 Boat Shaped 10' Top
  - 003 Square, 18" Single Pedestal Bases (3)

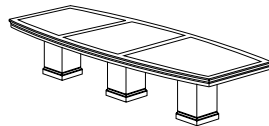

**12' BOAT TOP CONFERENCE TABLE**  
**7302-144**

- W144 x D36-48 x H30
- 006 Boat Shaped 12' Top
  - 003 Square, 18" Single Pedestal Bases (3)



**END TABLE**  
**7302-10**  
W24 D24 H20



**COFFEE TABLE**  
**7302-40**  
W50 D24 H16

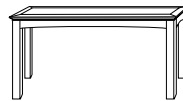

**SOFA/CONSOLE TABLE**  
**7302-82**  
W60 D16 H30



**EXECUTIVE HIGH BACK DESK CHAIR**

**7302-831, Black Leather**

**7302-832, Brown Leather**

W27.25 D30.75 H37.75 - 41.75

- Genuine leather upholstery with Sunset Cherry finished frame.
- Five star base with hooded casters.
- Swivel tilt mechanism.
- Gas lift.



**HIGH BACK GUEST CHAIR**

**7302-821, Black Leather**

**7302-822, Brown Leather**

W27.5 D28 H41

- Genuine leather upholstery with Sunset Cherry finished frame.



*DMI Office Furniture*  
*9780 Ormsby Station Road*  
*Ste 2000*  
*Louisville, KY 40223*  
*502.426.4351*  
*(Fax) 502.429.6285*  
*www.dmiofficefurniture.com*

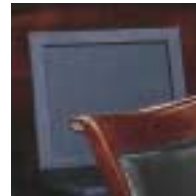

MEMBER  
**BIFMA**  
INTERNATIONAL